

THE HOLIDAY GLOBETROTTER



Camp-let[®]

- a Danish quality product

**USER INSTRUCTIONS
APOLLO / LUX, CONCORDE & SAVANNE**

Table of contents:

Introduction	3
Coupling	4
Erecting	5
Kitchen section	10
Technical specification	11
Remember before you go	12
Remember when you get home	13
Good advice	14
Details	14
Winter storage	16
Maintenance	17



Congratulations on your new tent trailer from Camp-let



These instructions are to be used after you have received your detailed Camp-let demonstration from your dealer.

We have gathered vast experience in the use and erection of Camp-let.

By studying these instructions carefully and following the good advice and demonstration given by your dealer, you can be sure to have many years and pleasure out of your Camp-let.



Coupling of the Camp-let



Hitch the trailer onto the tow ball and plug in the power.

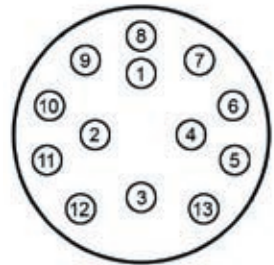
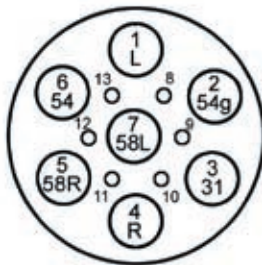
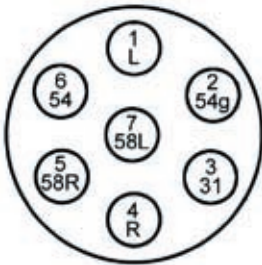

1	L	Indicator left	Yellow
2	54G	Fog light	Blue
3	31	Earth	White
4	R	Indicator right	Green
5	58R	Light right	Brown
6	54	Stop light	Red
7	58L	Light left	Black
9		Constant+	Grey

*only with 13 pole plug

Double check the Camp-let is firmly hitched to your car and check all the lights are working.

Erecting (find a level camping pitch)



Lower the front parking leg so the trailer is level.



The rear supporting legs have to be screwed down and adjusted, so that the trailer stands horizontal in both directions. The supporting legs must be screwed down so the wheels nearly clear the ground. Unlock the Camp-let.



Swing the kitchen out and tilt down the wire clamp. See "kitchen section".

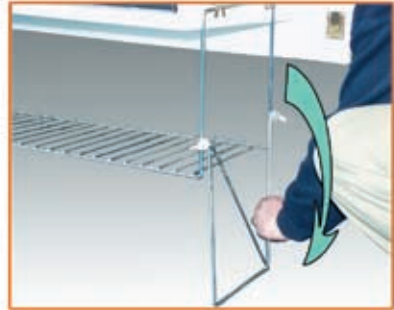

The kitchen support must be pivoted over 180 degrees, lowered down and then tighten the two thumb screws.



Remove the plastic stoppers from the luggage rack (keep the stoppers in a safe place).

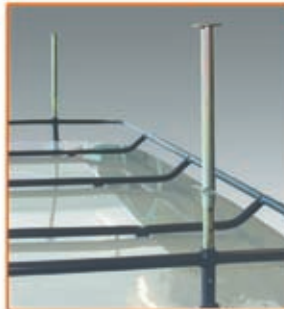

Fit the 2 bed supporting legs.



Release the catch.

Erecting...



Before the lid can be lifted, the internal catch must be released.



Take off the strap.



Lift the lid and slowly lower down.



The supporting legs must be adjusted, so that the lid is horizontal.



Pivot fitting in transport position. Pivot fitting prior to lifting out the canvas.



The protective sleeves must be removed (KEEP SAFE).



Connect the centre awning pole. Close all the zips.



Unfold the tent canvas so the canvas is draped over the trailer sides. Now check that the pivot fitting is still in the open position.



By holding the side poles carefully lift over the canvas. You must stop if you feel anything catching.



Ensure the canvas is sitting correctly on the reinforcements on all 4 corners.



Slide the awning poles out until the window is level. Tighten the pole collars.



Double check the windows are horizontal.



Savanne/Concorde: Before mounting the wardrobe bar, check the awning canvas is sitting correctly on the 4 corners of the roof.



Savanne/Concorde: Mount the roof sup. pole.



Savanne/Concorde: Mounting of front supporting pole.
To be adjusted after pegging.



Fitting the bottom skirt.



Apollo/Lux: Fitting the bottom skirt.
Savanne/Concorde: Fitting the bottom skirt with under bed storage.
Zip the skirt to the canvas on both sides before you do the press-studs.



The back rest strap goes through the inner tent then hooks onto the ring.
Replace the mattresses.



Mounting the pelmet with pockets. (Standard in Savanne/Concorde).

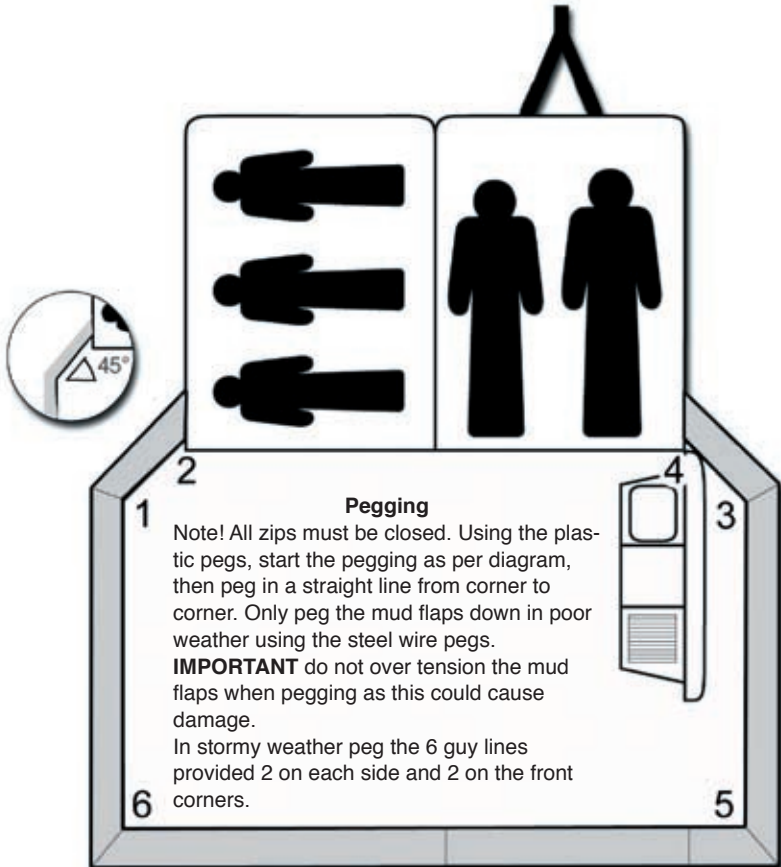

Kitchen section...



Open the kitchen and slowly swing it out checking that the electrical cable does not catch the bolts next to the hinge.



Pivot the supporting leg down, and tighten the wing nuts, so the kitchen is horizontal.



Gas pressure: 30 mBar.



Battery holder takes 2 x 6V batteries to run the water pump.



12V power point for minimum consumption.



Sink.

Technical specifications

Apollo/Lux

Dimension	17 m ²
Net weight	250 kg
Load capacity	250 kg
Total	500 kg

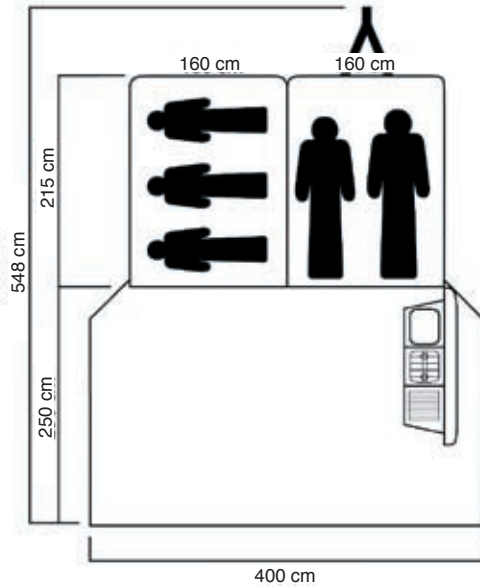

Concorde

Dimension	18 m ²
Net weight	250 kg
Load capacity	250 kg
Total	500 kg

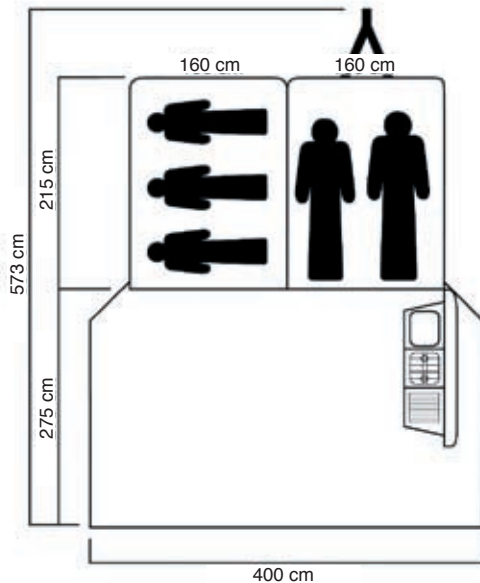

Savanne

Dimension	18 m ²
Net weight	275 kg
Load capacity	225 kg
Total	500 kg

Remember before you go...

Before setting off, the Camp-let must be packed with the weight evenly spread. The optimum tow hitch weight is 25-30 kg. The fibre glass trailer body has a 600 ltr. capacity (aprox). There is extra storage space on the luggage rack. It is better to load the Camp-let whilst it is up. Quilts, suitcases etc. must be loaded on the R-H bed (not the lid side). **IMPORTANT** – do not load too near the trailer sides, you must leave enough space for the canvas and the polework. Heavy items must be placed over the axle. **NOTE** – the maximum weight on the luggage rack is 75 kg. (evenly loaded over the rack). **DO NOT EXCEED THE MAXIMUM GROSS WEIGHT OF THE CAMP-LET**, (specified on the trailer plate).

Before you drive—check the following:

- 1: The Camp-let is correctly hitched onto the tow ball.
- 2: That the front and rear supporting legs are up.
- 3: All the lights are working.
- 4: The trailer lid and kitchen are correctly closed and locked.
- 5: Control that the air pressure in the tyres are 28 psi (2 Bar).

You would be well advised to take a spare wheel.

Whilst travelling, remember the Camp-let is hitched on.



Remember when you get home...

If you have packed away the Camp-let wet or even slightly damp, you must set up and completely dry it out (within 24 hours).

If you have been travelling in wet conditions you must open up the Camp-let (within 24 hours) to check that water has not seeped in.

Carry out the same check after you wash the Camp-let.

**FAILURE TO FOLLOW THIS ADVICE WILL CAUSE DAMP STAINES
- MILDEW - ROT AND A LARGE REPAIR BILL.**



Good advice...

Dismantling is in reverse order, remember to fold down the back rest and lye the cushions in the bottom of the trailer. Remove the centre awning pole and put the protective sleeves on. Take care not to trap the canvas under the lid and around the kitchen area. Front and rear clamps must be closed and the kitchen is locked. Remember to wind up the rear steadies.

After you have taken delivery from your dealer you will have been given a detailed demonstration, it is recommended to set it up at home for two reasons. Firstly to further familiarise yourself and secondly to weather the canvas. Peg the canvas down then expose the canvas to rain or morning dew. To avoid shrinkage, the canvas must be evenly pegged out until bone dry. Once the canvas is dry it is then weathered and waterproof.

Also consider:

- 1 mobile mains kit (230V)
- lights for cabin and awning
- awning groundsheet

Details: Apollo / Lux



The veranda window semi-opened



The kitchen window opened and rolled

Details: Concorde & Savanne



Ventilation for the sleeping compartments.



Kitchen window guyed out for ventilation.



Curtain clips.

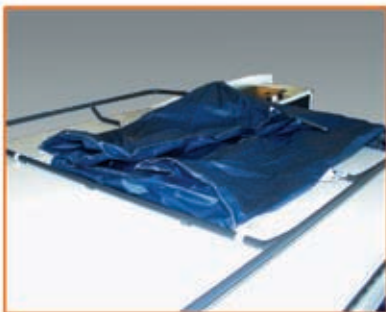

The under bed storage can be mounted before the lid is lifted over.



The entire side window can be zipped/rolled up, so the window area is one big mosquito net.



The veranda doors/windows can be totally or partially opened.

Winter storage

Clean the tent for stains/spots and clean the mud flap. The canvas can be removed by opening the zip pockets on the poles and slide out the canvas from the tent rail.

Canvas and mattresses must be kept dry. Wash the glass fibre body with a mild soap. Hinges, fasteners, spindles, coupling and connecting link etc. must be lubricated.

The optimum way to store the Camp-let is in the garage or carport. It is possible to store the Camp-let on its side (in a garage) using Camp-let side storage brackets available from your dealer.

If the Camp-let must be stored out side, the tent – mattresses – inner tents – etc. must be removed and stored indoors.



Regular maintenance...

Tent:

Clean the canvas and mud flaps (ask your dealer for advice). Remember if the canvas is wet or damp always thoroughly dry it within 24 hours. Canvas and stitching can be waterproofed again if necessary (ask your dealer for advice).

Glass fibre body:

Wash the body with a mild soap, which does not contain abrasive. The body should at least once a year be waxed with car wax.

Wheels, axles & hinges:

Check the wheel bearings for slackness and abnormal sounds. If your Camp-let is fitted with overrunning brakes, disconnect the brake drum, check the brake linings and remove brake dust.

Lubricate the links and cables and adjust the brakes (to be done once a year or for every 3000 km). Check the tyres for wear and tear, or a possible puncture. For inspection, use the rear supporting legs as a jack (also use the winding handle as wheel wrench).

Re-tighten the wheels, axles and coupling etc. (to be done for every 3000 km).



List of framework



- 1: Wardrobe rail, Concorde & Savanne
- 2: Roof supporting pole, Concorde & Savanne
- 3: Front supporting pole, Concorde & Savanne
- 4: Veranda bar (side window), Concorde
- 5: Veranda bar (front window), Concorde & Apollo/Lux
- 6: Ventilation, Concorde & Savanne
- 7: Ventilation (kitchen window), Concorde

Available accessories



Insulation mats



Gas box



Jockey wheel and supporting leg



Tarpaulin protects against dirt

The Camp-let factory stands for quality through a new standard in design, materials and construction. For more than 40 years we have developed and produced trailers and trailer tents in our Danish factory. The product program today includes Camp-let trailer tents as well as Euro-trailer and Mustang horse trailer.



Camp-let[®]

- a Danish quality product

Camp-let A/S · Arnum : DK- 6510 Gram
Tel. +45 74 82 61 35 : Fax +45 74 82 65 80
www.camp-let.dk